

**GARAMPANI BLOCK SUMMARY
PART A**

Sr. No.	Features	Details
1.	Location	
	Coal Block	Garampani
	Latitude	25° 28' 41" N - 25° 29' 37" N (Provisional)
	Longitude	92° 34' 57" E - 92° 35' 51" E (Provisional)
	Topo Sheet No.	83C/11
	Coalfield	Dima Hasao
	Villages	-
	Tehsil/Taluka	-
	District	Dima Hasao
	State	Assam
2.	Connectivity with Block	
	Nearest Rail Head	-
	Road	The area is connected with the Garampani town by 16 km long fair weather road while garampani be approached by lanka-garampani road.
	Airport	-
3.	Area	
	Geological Block Area	1.09 sq km (As supplied by DGM, Assam,)
	Green Cover	-
	Area excluding green cover	-
4.	Climate and Topography	
	Average Annual Rainfall	-
	Temperature (Min. — Max.)	-
	Local Surface Drainage Channels	The block is bordered by Kopili River in the west and North.
	Rivers	Kopili River, outside the block in North and West.
5.	Exploration	
	Status	Explored
	Exploration Agency	DGM, Assam
	Total Number of Boreholes with meterage	13 Boreholes; 447.50 m

	Borehole Density	11.92 Boreholes per Sq.Km.			
	General Dip of Seams	The sedimentary rocks are dipping low towards S-E direction with local variations caused by post depositional tectonic disturbances, such as faulting and minor folding.			
	General Strike Direction	The general trend of sedimentary rocks of Basal sandstone formation is NE-SW.			
	Faults	The coal is mostly affected by post depositional fault and trend ranges from N40E to N70E with local deviation to N-S, NW-SE directions and dipping low (2 to 10) towards S-E direction. The sedimentary rocks are affected by joints having the trend of N65E to N80E and have the slip plans at 30 to 80 (in few cases) angles.			
6.	Coal Seams & Reserve				
	Coal Seams	Thickness Range (m)	Depth Range (m)	Resources (mt)	Grade
	Seam-1	0.10-1.05	18.50-26.50		
	Seam-2	0.20-1.10	21.20-30.70		
	Seam-3	0.30-0.60	25.20-35.10		
	Total			0.468	G5-Ungraded
7.	Surface Constraints				
8.	Grade of coal	G5 (Provisional) Based on the quality of coal given in the geological note/report.			
9.	Decision Support System (DSS) Analysis	Information not available.			
10.	Eco Sensitive Zone (ESZ)	Information not available.			
11.	CBA Land Acquisition Status	Information not available.			

PART B

Sr. No.	Features	Details
1	Tentative Peak rated Capacity	0.02 Mty

Note:

1. The summary has been compiled from "Report on Garampani Coal Deposit, Dima Hasao, Assam." Prepared by DGM-Assam.
2. The block boundary map is prepared based on the data provided by DGM, Assam. DGPS survey is required to ascertain the block boundary.

Disclaimer:

1. The analysis is done on Beta-version (Trial Version) of Decision Support System (DSS) of FSI / MOEF.
2. The Decision Rules for various parameters of this DSS System are controlled by FSI.
3. CMPDI only runs this DSS to obtain the status of any block based on these Decision Rules.
4. The database of the Decision Rules is updated by FSI from time to time.
5. CMPDI does not own any responsibility for variation in the results which are based on the Decision Rules of the FSI DSS in case of any updation of the database at FSI end.

6. ESZ analysis and tiger habitat/ corridor given here is based on the information available in public domain. Bidders are encouraged to verify this information and any other information additionally available.

Garampani Block, North Eastern Region

FOR INTERNAL/RESTRICTED USE ONLY

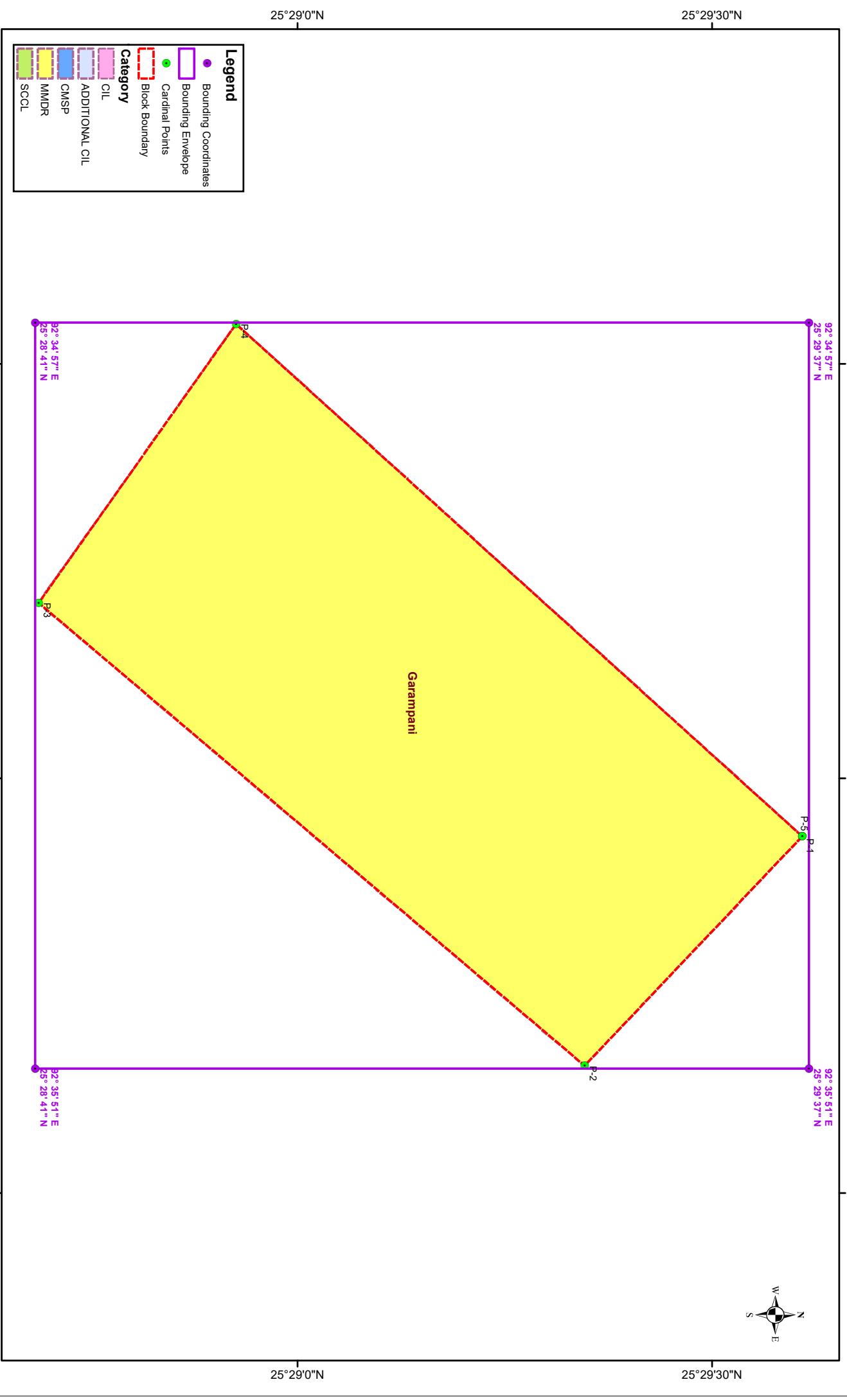

Note: Data is in WGS84 coordinate system.

25°29'0"N

25°29'30"N

25°29'0"N

25°29'30"N

92°35'0"E

92°35'30"E

92°36'0"E

92°35'0"E

92°35'30"E

92°36'0"E



Provisional Cardinal Points for Garampani Block

POINT NO	Longitude (WGS84)	Latitude (WGS84)
P-1	92° 35' 34.188" E	25° 29' 36.512" N
P-2	92° 35' 50.785" E	25° 29' 20.775" N
P-3	92° 35' 17.290" E	25° 28' 41.266" N
P-4	92° 34' 57.113" E	25° 28' 55.544" N

Note: The provisional cardinal points are in WGS84 coordinate system. These points are extracted through ArcGIS software after georeferencing of block boundary and onground DGPS survey is required to ascertain the exact location of the points.